

SPECIFICATIONS: OFFICE FURNITURE

SPED STAFF

- | | |
|---|----|
| 1. SYSTEM CABINET WITH LOCKS (Black)
Wooden door system cabinet with 3 shelves
Size: 900 L x 450 W x 1500 H | 45 |
| 2. 4 Tier bookcase
Size: 900 L x 400W x 1500 H | 1 |
| 3. 4 Wooden door with lockable doors
Size: 1800 x 450 x 1200
2 shelves inside | 3 |
| 4. High Back Fabric chair black
Black netting material finish, plastic armrest,
Five star base | 10 |
| 5. 4 Drawers Filing cabinet
Size: 490 l x 600 W x 1360 H | 1 |
| 6. Four way Cluster Desk
Desk size: 1800 x 1200 W x 800 H
Pedestal size: 420 L x 550 W x 800 H | 5 |

COLOUR IS MAHOGANY UNLESS MENTIONED ON ITEMS

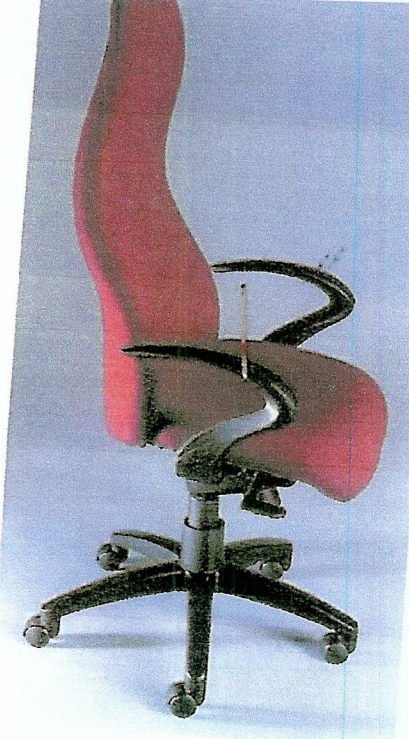

* 4

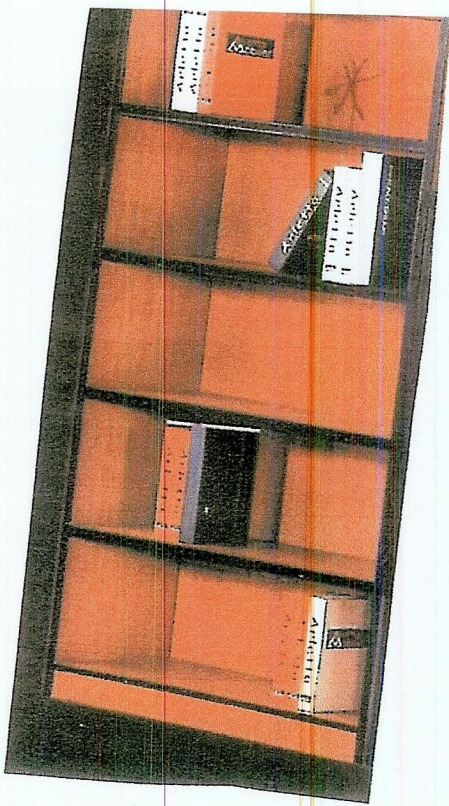

* 2

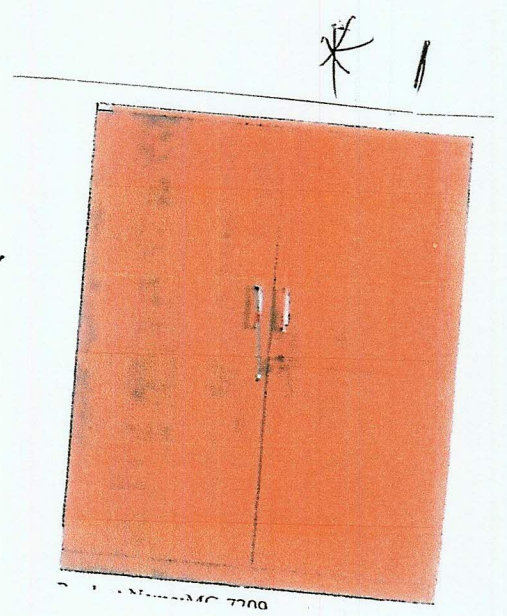

* 1

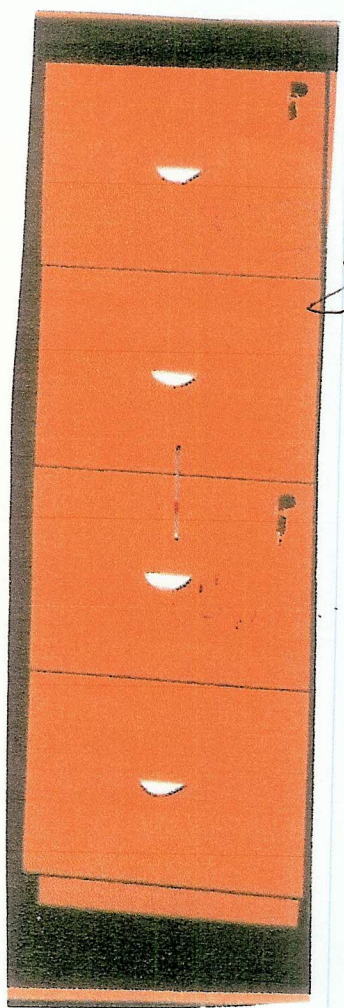

* 5

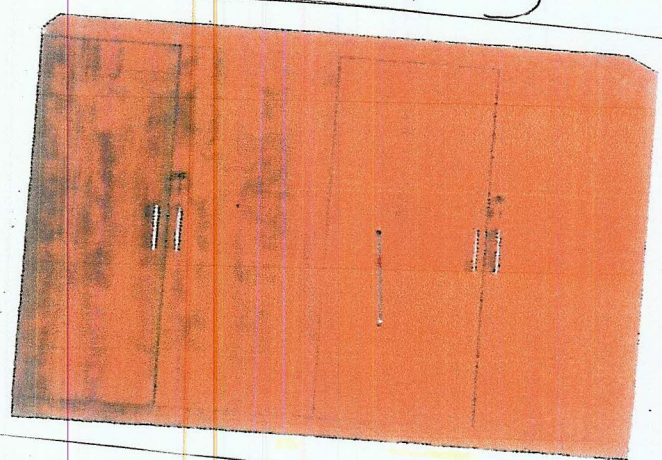

* 3



* 6
Desk